

Maytag MAV8600AWQ 03 - CABINET (SER PRE 18 & AFTER)

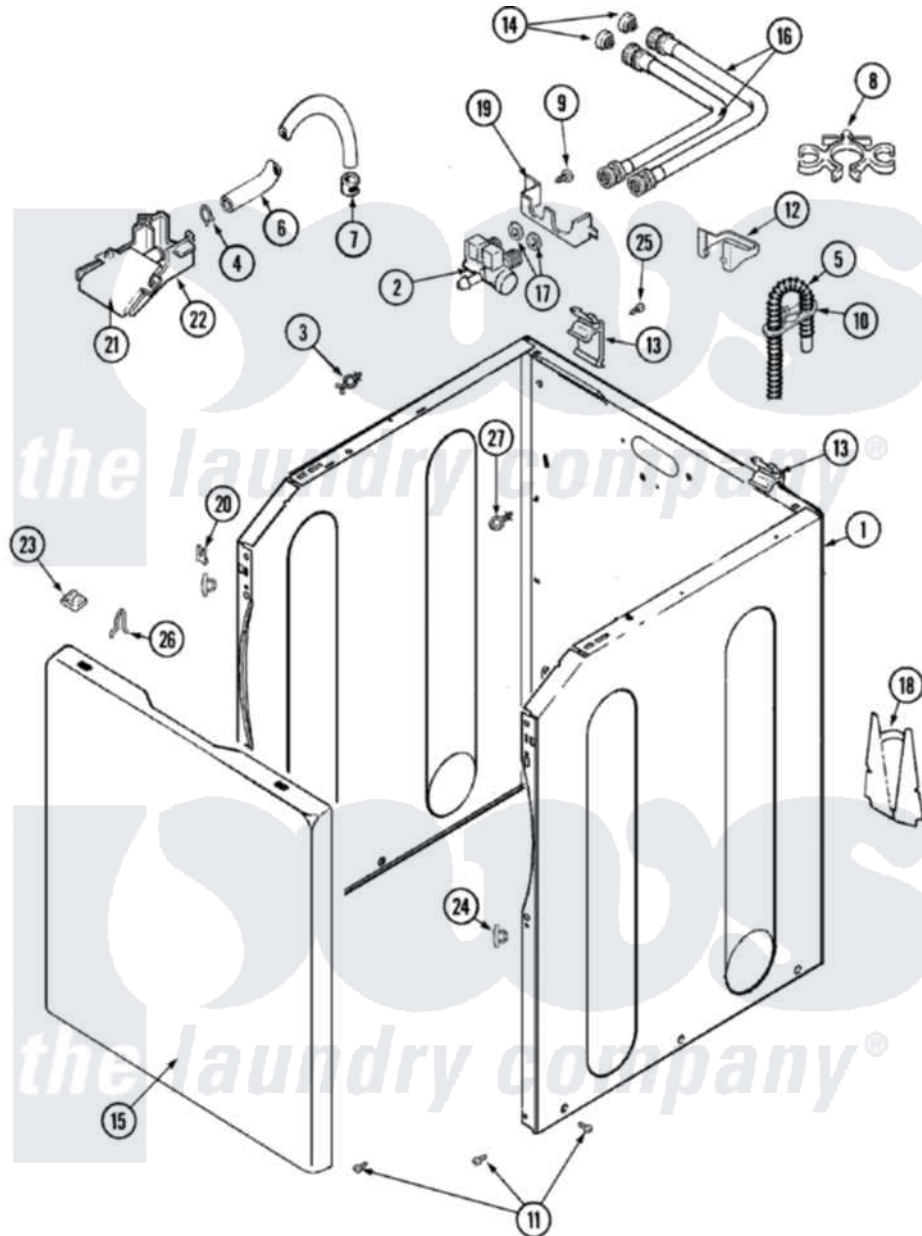

Maytag Residential Maytag MAV8600AWQ Washer Parts Parts Diagram 03 - CABINET (SER PRE 18 & AFTER)
 Click on the part number to view part

Item	Original Part Number	Replaced By	Status	Part Description
1	22003554			Cabinet Assembly
"	22002840			Brace, Cabinet
"	22003496			Energy Tag
"	22002839			Brace, Cabinet
"	33002190			SCrew, C BraCe, BraCket, Cabinet
2	22003372	12002158		Valve-Inlet
3	22002852	22003298		Retainer, Wire
4	22002838	285655		Clamp, Hose
5	22003410			Hose, Drain
"	22003596	285655		Clamp, Hose
6	22002761			Hose, Injector
7	216169	596669		Clamp, Manifold
8	22002765			Clip, Hose
9	33002190			SCrew, C BraCe, BraCket, Cabinet
10	22002701	22003814		Retainer, Drain Hose

11	22003409	213007	Xfor Cabinet See Cabinet, Back
12	22003429		Retainer, Fill Hose
13	22003367	22004095	Hinge, Plastic
14	200961	12001413	Strainer And Washer Kit
15	22002293	22003511	Insulation
"	Y22002738		Panel, Front
"	22002854	22003512	Insulation, Cabinet
"	33002190		SCrew, C BraCe, BraCket, Cabinet
16	22002763	12001900	Kit-Inlet Hose Assembly
"	22002764	12001901	Kit-Inlet Hose Assembly
17	Y013783		Washer, Inlet Hose
18	22002704		Cover, Drain Hose
"	33002190		SCrew, C BraCe, BraCket, Cabinet
19	22003376		Bracket, Water Valve
20	22002748	204439	Screw And Fstner Assembly
21	22003374		Upper Water Injector, Flume
22	22003375	22004053	Lower Injector, Flume
23	22002013		Stop, Shipping
24	22002965	Y12001702	Kit- Plast
25	22001995		Screw Note: Screw, Tumbler Front And Shroud
26	25-7220		Clip, Cabinet Top
27	22003086		Clip, Air Dome Hose
28	35-2890	8539404	Tie-Wire
"	33001245		Screw---NA
"	33002388		Washer
"	Y013783		Washer, Inlet Hose
"	22002960		Strainer, Washer Inlet

