

# Maytag MFS50PNAVS 13 - ELECTRICAL COMPONENTS

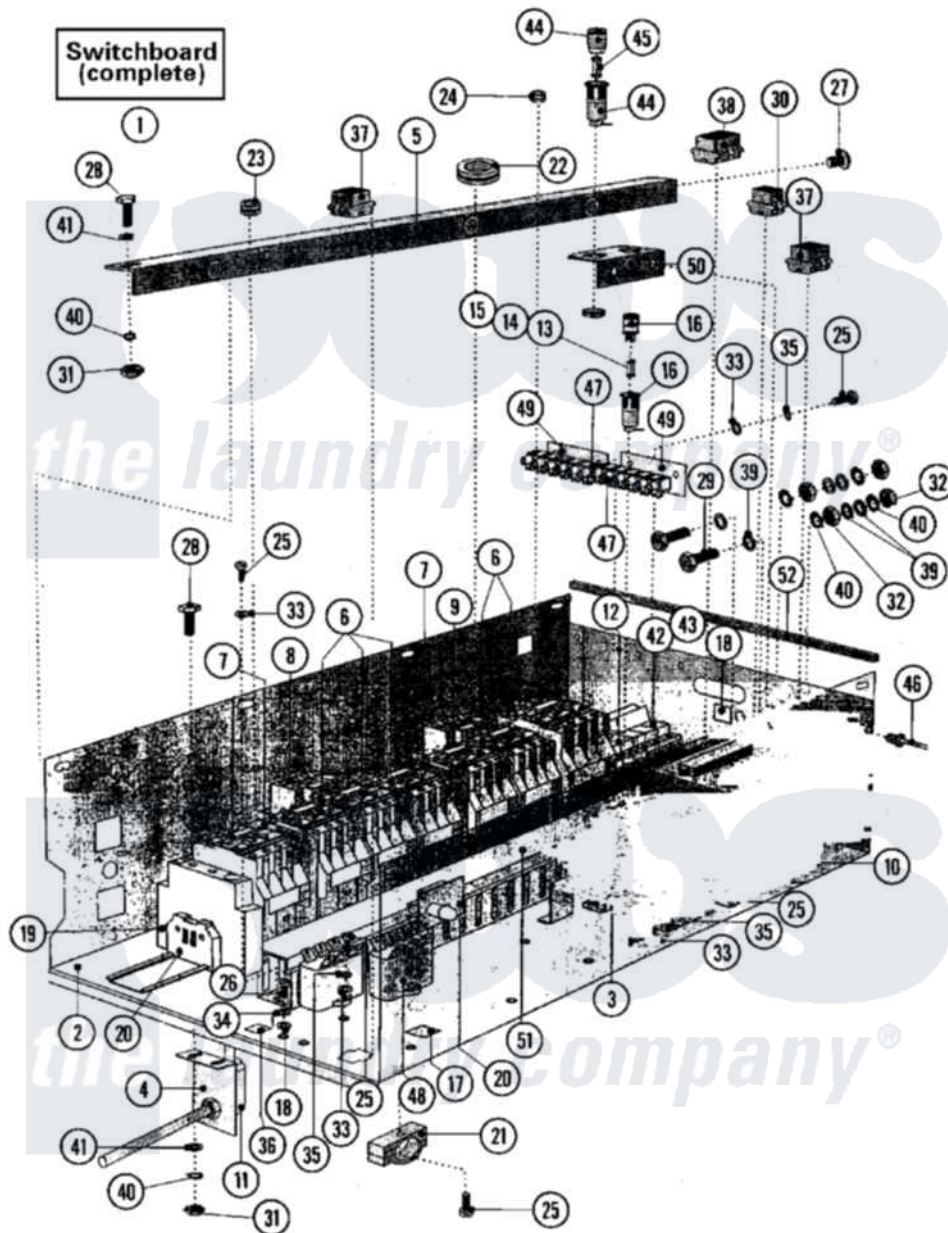

Maytag [Residential Maytag MFS50PNAVS Washer Parts](#) Parts Diagram 13 - ELECTRICAL COMPONENTS  
 Click on the part number to view part

| Item | Original Part Number     | Replaced By              | Status        | Part Description                    |
|------|--------------------------|--------------------------|---------------|-------------------------------------|
| 001  | <a href="#">23003150</a> |                          |               | Switchboard                         |
| 002  | <a href="#">23003151</a> |                          |               | Board, Switchboard Lu               |
| 003  | NLA                      |                          | Not Available | HOLDER, FUSE                        |
| 004  | NLA                      |                          | Not Available | HOLDER, VIBRATION SWITCH            |
| 005  | NLA                      |                          | Not Available | HOLDER (COMPLETE)                   |
| 006  | 23001101                 | <a href="#">23003751</a> |               | Contactor Lc1 D12                   |
| 007  | 23001119                 | <a href="#">23003762</a> |               | Mechanical Interlock                |
| 008  | <a href="#">23001106</a> |                          |               | Relay, Thermal Overload             |
| 009  | 23001105                 | <a href="#">23003761</a> |               | Overload Relay LR2D                 |
| 010  | 23002142                 | <a href="#">23003708</a> |               | Transformer Control Brd             |
| "    | <a href="#">23003704</a> |                          |               | Transformer Use On Model Mfs125pavs |
| 011  | <a href="#">23002775</a> |                          |               | Switch, Vibration                   |
| 012  | <a href="#">23001094</a> |                          |               | Bridge, Rectifier                   |
| "    | <a href="#">23001717</a> |                          |               | Breaker, Circuit                    |
| "    | NLA                      |                          | Not Available | PARTS, CONTACT                      |

|     |                          |                          |                                 |
|-----|--------------------------|--------------------------|---------------------------------|
| 013 | <a href="#">23002838</a> |                          | Fuse                            |
| 014 | <a href="#">23001463</a> |                          | Fuse                            |
| 015 | <a href="#">23002043</a> |                          | Fuse                            |
| 016 | <a href="#">23001462</a> |                          | Holder, Fuse                    |
| 017 | NLA                      | Not Available            | LABELS, DESCRIPTION             |
| 018 | NLA                      | Not Available            | LABEL, EARTH                    |
| 019 | <a href="#">23003155</a> |                          | Parts, Contactor                |
| 020 | <a href="#">23002110</a> |                          | Terminal Wago                   |
| 021 | <a href="#">23002428</a> |                          | Clip, Cable                     |
| 022 | <a href="#">23001117</a> |                          | Ring, Rubber                    |
| 023 | NLA                      | Not Available            | PASSAGE, CABLE (13 X 2)         |
| 024 | NLA                      | Not Available            | BUSHING, RUBBER                 |
| 025 | 23001609                 | <a href="#">23002721</a> | Screw                           |
| 026 | <a href="#">23002650</a> |                          | Screw                           |
| 027 | NLA                      | Not Available            | SCREW (M6X10)                   |
| 028 | <a href="#">23002649</a> |                          | Screw                           |
| 029 | <a href="#">23002806</a> |                          | Screw                           |
| 030 | <a href="#">23002154</a> |                          | Housing, Connector              |
| 031 | 23002651                 | <a href="#">23001312</a> | Mut M6                          |
| 032 | 23001515                 | <a href="#">23001312</a> | Mut M6                          |
| 033 | 23001610                 | <a href="#">23002438</a> | Washer M4.3                     |
| 034 | <a href="#">23002129</a> |                          | Washer                          |
| 035 | <a href="#">23002400</a> |                          | Washer                          |
| 036 | 23002656                 | <a href="#">23001573</a> | Washer                          |
| 037 | <a href="#">23001722</a> |                          | Board, Terminal                 |
| 038 | <a href="#">23002798</a> |                          | Board, Terminal                 |
| 039 | <a href="#">23002726</a> |                          | Washer                          |
| 040 | 23002357                 | <a href="#">23002440</a> | Washer, Spring Lock             |
| 041 | 23002282                 | <a href="#">23001027</a> | Washer                          |
| 042 | <a href="#">23003158</a> |                          | Fuse, Disconnecter              |
| 043 | <a href="#">23002802</a> |                          | Disconnecter, Fuse              |
| 044 | <a href="#">23002210</a> |                          | Holder, Fuse                    |
| 045 | 23003159                 | <a href="#">Y0072211</a> | Fuse, 5 Amp                     |
| 046 | NLA                      | Not Available            | RIVET                           |
| 047 | <a href="#">23002154</a> |                          | Housing, Connector              |
| 048 | 23001518                 |                          | SERIES 15 - NO LONGER<br>NEEDED |
| "   | NLA                      | Not Available            | NET FILTER                      |
| 049 | <a href="#">23001115</a> |                          | Terminal Block Insulation       |
| 050 | NLA                      | Not Available            | HOLDER, FUSES                   |
| 051 | <a href="#">23001551</a> |                          | Gutter, Cable                   |
| 052 | 23001088                 | <a href="#">23002473</a> | Rubber, Protective              |