

# Maytag MFX100PAVS 01 - SOAP INJECTION & ACCESSORIES

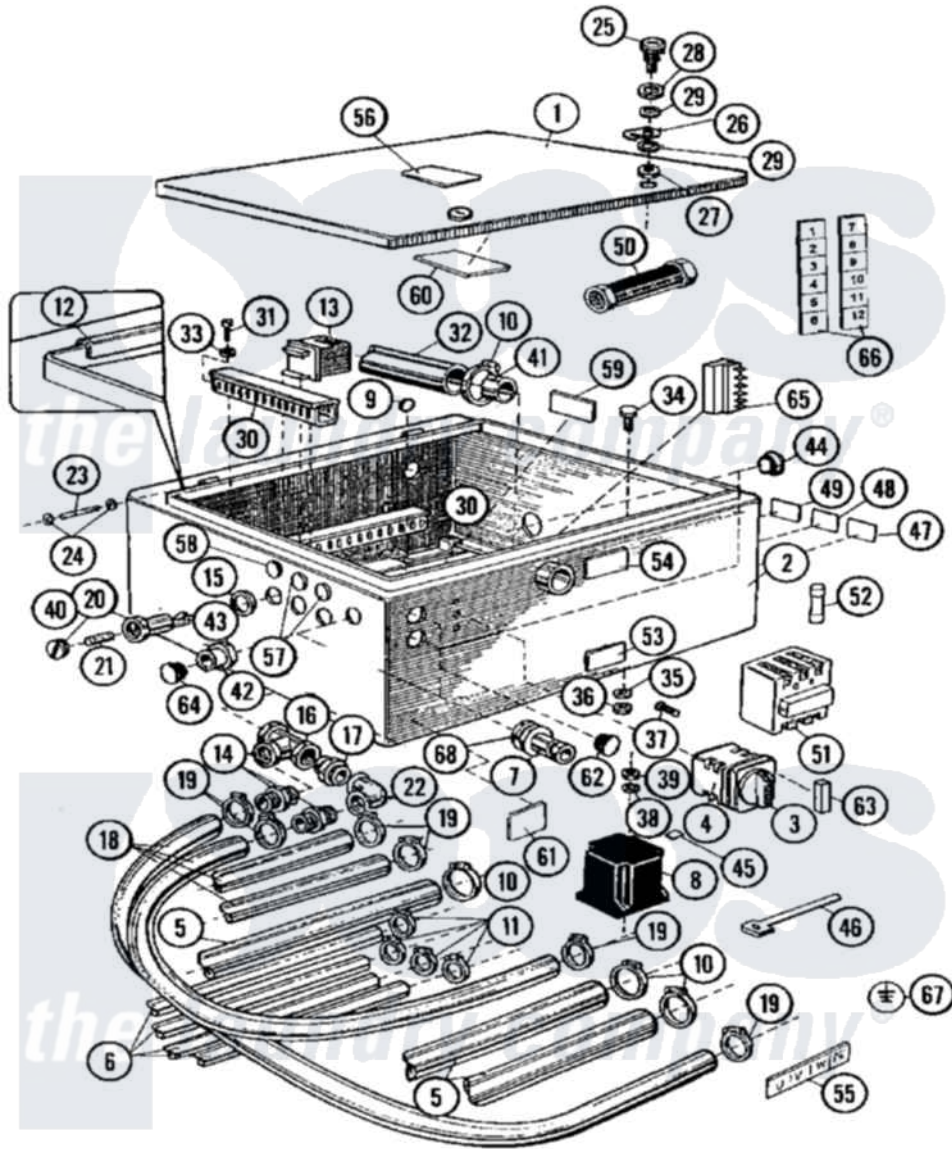

Maytag [Residential Maytag MFX100PAVS Washer Parts](#) Parts Diagram 01 - SOAP INJECTION & ACCESSORIES  
 Click on the part number to view part

Item	Original Part Number	Replaced By	Status	Part Description
001	<a href="#">23002021</a>			Cover, Electrical Box
002	<a href="#">23002020</a>			Box, Distributor
003	<a href="#">23002141</a>			Device, Operating
004	<a href="#">23002022</a>			Switch, Main
005	<a href="#">23002023</a>			Hose, Inlet
006	<a href="#">23001507</a>			Waterhose
007	NLA		Not Available	SWIVEL, CABLE
008	23002142	<a href="#">23003708</a>		Transformer Control Brd
"	<a href="#">23003704</a>			Transformer Use On Model Mfs125pavs
009	<a href="#">23002143</a>			Nipple
010	23001261	<a href="#">616099</a>		Clamp
011	23001506	<a href="#">596669</a>		Clamp, Manifold
012	23001088	<a href="#">23002473</a>		Rubber, Protective
013	<a href="#">23001102</a>			Contactora
014	<a href="#">23001727</a>			Connection, Tube
015	<a href="#">23001743</a>			Ring, O

016	<a href="#">23001485</a>		Tee, 3/4" Pipe Thread
017	<a href="#">23001482</a>		Connection
018	<a href="#">23001740</a>		Hose
019	23001262	<a href="#">616099</a>	Clamp
020	<a href="#">23001462</a>		Holder, Fuse
021	<a href="#">23001463</a>		Fuse
"	<a href="#">23002043</a>		Fuse
022	<a href="#">23001756</a>		Elbow
023	<a href="#">23001690</a>		Screw, Distance
024	<a href="#">23001056</a>		Ring, Shaft Locking
025	<a href="#">23001006</a>		Lock, Top Panel
026	<a href="#">23001009</a>		Hook, Lock
027	<a href="#">23001011</a>		Nut
028	<a href="#">23001008</a>		Nut, Lock
029	<a href="#">23001007</a>		Washer M21x27x1
030	<a href="#">23001551</a>		Gutter, Cable
031	<a href="#">23001361</a>		Bolt
032	NLA	Not Available	HOSE, VENT
033	<a href="#">23001708</a>		Washer
034	<a href="#">23001026</a>		Bolt
035	<a href="#">23001027</a>		Washer
036	23001034	Not Available	NUT (M6)
037	<a href="#">23001361</a>		Bolt
038	<a href="#">23001708</a>		Washer
039	23001334	<a href="#">8184504</a>	Nut
040	<a href="#">23002210</a>		Holder, Fuse
041	BLANK	Not Available	SOCKET
042	<a href="#">23002196</a>		Protector, Cable
043	<a href="#">23002197</a>		Med. Strain Relief Nut
044	NLA	Not Available	PACKING, MULTI-PURPOSE
045	<a href="#">23002025</a>		Label, Electrostatic Sensitive
046	<a href="#">23001720</a>		Binder, Cable
047	<a href="#">23001469</a>		Sticker, Hot Water
048	<a href="#">23001471</a>		Sticker, Cold Soft Water
049	NLA	Not Available	STICKER, COLD HARD WATER
050	<a href="#">23002057</a>		Hose, Water Inlet
"	<a href="#">23003973</a>		Washer, Fill Hose
051	BLANK	Not Available	DISCONNECTER, FUSE
052	BLANK	Not Available	FUSE
053	<a href="#">23001468</a>		Sticker, Spin Direction
054	<a href="#">23002053</a>		Label, Warning Vent Out
055	NLA	Not Available	LABEL (U V W PE)
056	NLA	Not Available	LABEL (ELECTRIC HEATING)
057	NLA	Not Available	LABEL (4A)
058	23001744	Not Available	LABEL (2A)
059	NLA	Not Available	LABEL, WARNING EL. TENSION
060	<a href="#">23001550</a>		Sticker, Service Warning
061	<a href="#">23001465</a>		Sticker, Electricity Warning
"	NLA	Not Available	LABEL, WARNING (IMPORT)
062	NLA	Not Available	BLIND, UNIVERSAL
063	23002151	Not Available	(WITHOUT HEATING)

"	23002152	Not Available	(ELECTRICAL HEATING)
"	NLA	Not Available	CONTACT ("N")
064	<a href="#">23002153</a>		Plug
065	<a href="#">23002154</a>		Housing, Connector
066	23002218		LABEL, TERMINAL BOARD
067	NLA	Not Available	LABEL, EARTH
068	<a href="#">23002197</a>		Med. Strain Relief Nut

