

Maytag MFX50PNAVS 12 - SOAP INJECTION & ACCESSORIES

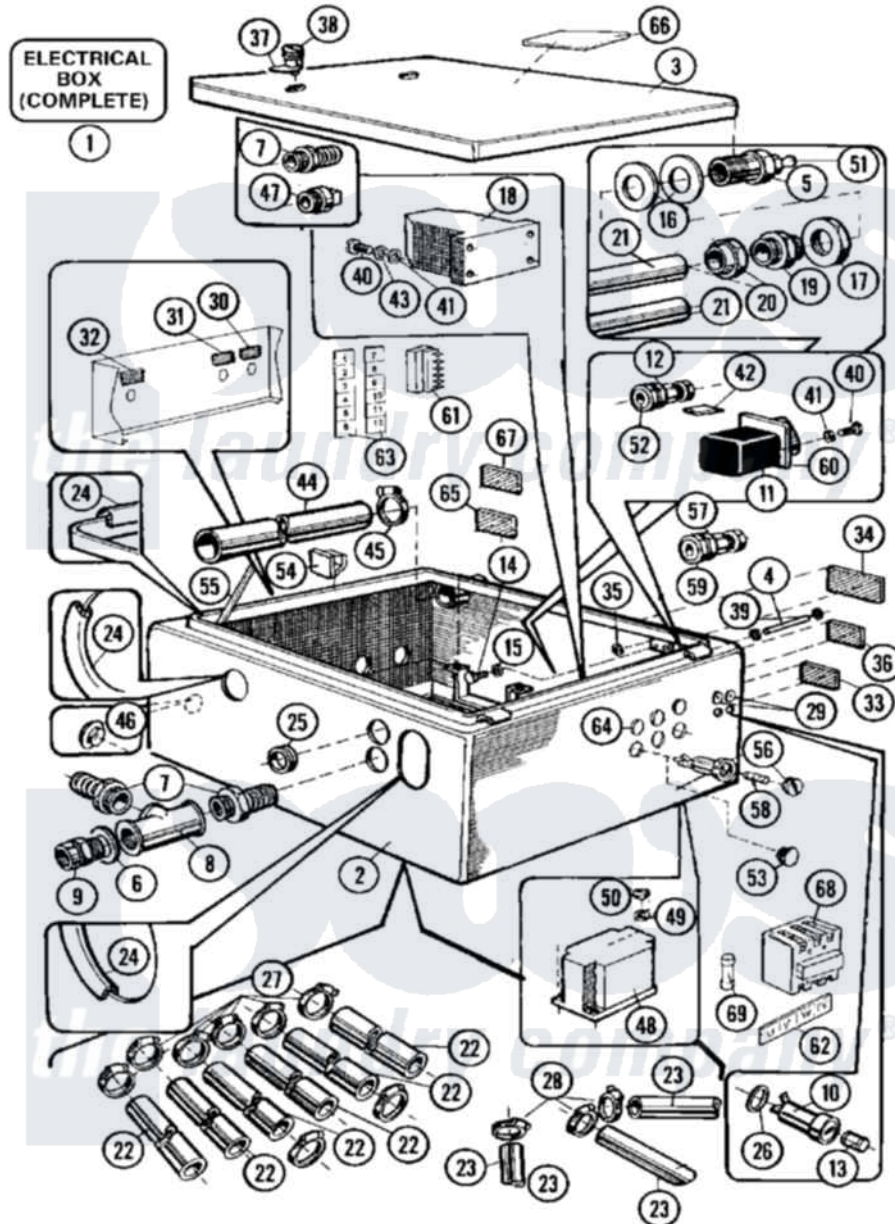

Maytag [Residential Maytag MFX50PNAVS Washer Parts](#) Parts Diagram 12 - SOAP INJECTION & ACCESSORIES
 Click on the part number to view part

Item	Original Part Number	Replaced By	Status	Part Description
001	NLA		Not Available	BOX, ELECTRICAL (COMPLETE)
002	NLA		Not Available	BOX, ELECTRICAL
003	NLA		Not Available	COVER, ELECTRICAL BOX
004	23001690			Screw, Distance
005	23001726			Adaptor, Lubrication Nipple
006	23001483			Washer
007	23001727			Connection, Tube
008	23001485			Tee, 3/4" Pipe Thread
009	23001729			Tube, Extension
010	23001462			Holder, Fuse
011	23001731	23003502		Switch, Main
"	NLA		Not Available	LOCK, MAIN SWITCH (63A)
012	23002196			Protector, Cable
013	23001463			Fuse
014	23001733			Screw
015	23001734	23002425		Locker Washer M6

016	23002246		Washer
017	23001736		Nut
018	23001103		Contactora
019	23001737		Branch, Connecting
020	23001738		Nut, Traveling
021	23001739		Hose, Grease
022	23001740		Hose
023	23001507		Waterhose
"	23003707		Check Valve
024	23001088	23002473	Rubber, Protective
025	NLA	Not Available	PASSAGE, CABLE (22X2)
026	23001743		Ring, O
027	23001262	616099	Clamp
028	23001506	596669	Clamp, Manifold
029	23001744	Not Available	LABEL (2A)
030	23001469		Sticker, Hot Water
031	23001471		Sticker, Cold Soft Water
032	NLA	Not Available	LABEL (COLD SOFT WATER)
033	NLA	Not Available	LABEL (WARNING)
034	23001550		Sticker, Service Warning
035	NLA	Not Available	LABEL, EARTH
036	23002307		LABEL, LUBRICATING
037	23001006		Lock, Top Panel
038	23001009		Hook, Lock
039	23001056		Ring, Shaft Locking
040	23001748	23002721	Screw
041	23001013		Lock Washer External Teeth M4
042	23002308		LABEL, WARNING UNDER CURRENT
043	23001056		Ring, Shaft Locking
044	23002309		Hose, Air-Venting
045	23001750		Ring, Clamp
046	23001476		Plug, Water Inlet
047	23001604	23002480	Plug
048	23002142	23003708	Transformer Control Brd
"	23003704		Transformer Use On Model Mfs125pavs
049	23001333	23004485	Lock Washer M5
050	23001334	8184504	Nut
051	23001753		Nipple, Lubricating
052	23002197		Med. Strain Relief Nut
053	23002153		Plug
054	NLA	Not Available	HOOK, STICK
055	NLA	Not Available	SUPPORT
056	23002210		Holder, Fuse
057	23002211		Swivel, Cable
058	23002310		Fuse
059	23002212		Bushing Nut
060	23002141		Device, Operating
061	23002154		Housing, Connector
062	NLA	Not Available	LABEL (U V W PE)
063	23002218		LABEL, TERMINAL BOARD

064	NLA	Not Available	LABEL (4A)
065	23002053		Label, Warning Vent Out
066	23002312	Not Available	LABEL, FLASH
067	23002297		LABEL, HEATWARNING
068	BLANK	Not Available	DISCONNECTER, FUSE
069	BLANK	Not Available	FUSE
070	23001551		Gutter, Cable

