

**Maytag MLG32PDBWA 12 - GAS VALVE ASSEMBLY (PRIOR TO YW SERIALNo.)**

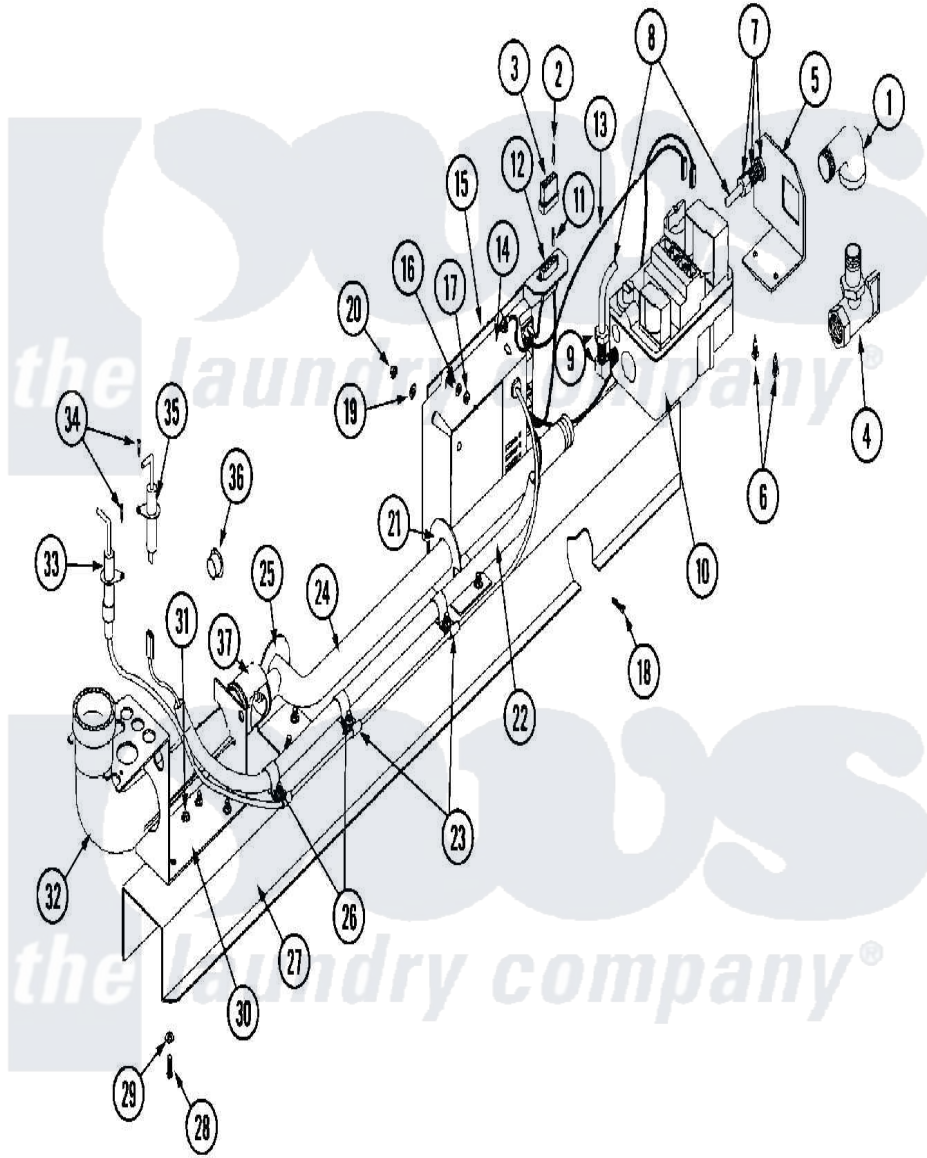

Maytag Residential Maytag MLG32PDBWA Dryer Parts Parts Diagram 12 - GAS VALVE ASSEMBLY (PRIOR TO YW SERIALNo.)

Click on the part number to view part

| Item | Original Part Number | Replaced By               | Status        | Part Description                                     |
|------|----------------------|---------------------------|---------------|--|
| 000  | W10124350            |                           | Not Available | ORDER PARTS FROM AMERICAN DRYER CORP AT 508-678-9000 |
| 001  | A142506              | <a href="#">142506</a>    |               | 1 2 X 1 2  |
| 002  | A122700              | <a href="#">122700</a>    |               | MNL Pin S  |
| 003  | A122604              | <a href="#">W10146714</a> |               | 4 Pin Cmnl   |
| 004  | A881367              | <a href="#">W10148314</a> |               | 1 2 Un   |
| 005  | A318712              | <a href="#">318712</a>    |               | 320 330 43   |
| 006  | A150301              | <a href="#">150301</a>    |               | 8-18 X 7   |
| 007  | A143259              | <a href="#">143259</a>    |               | Bulkhd Fit   |
| 008  | A143100              |                           | Not Available | TUBING, ALUMINUM (1/4")                              |
| 009  | A143203              | <a href="#">143203</a>    |               | Pnp Pilot  |
| 010  | A128927              |                           | Not Available | VALVE, GAS (REDUNDANT) (1/2" 24 VAC, NATURAL GAS)    |
| "    | A140411              |                           | Not Available | CONVERSION KIT (1/2" 24 VAC GAS VALVE (L.P.) W/O     |

|     |                         |                           | ORIFICES                     |
|-----|-------------------------|---------------------------|------------------------------|
| 011 | A122701                 | <a href="#">122701</a>    | MNL Socket                   |
| 012 | A122605                 | <a href="#">122605</a>    | 4 Pin Cmnl                   |
| 013 | A842716                 | <a href="#">842716</a>    | 330 Gas TR                   |
| "   | A842724                 | <a href="#">842724</a>    | 330 Gas TR                   |
| 014 | A880815                 |                           | MODULE, DSI (50HZ/60HZ)      |
| 015 | A850808                 | <a href="#">W10147723</a> | 330 430 Ds                   |
| 016 | A153017                 | <a href="#">153017</a>    | 6 Sae Was                    |
| 017 | A151000                 | <a href="#">WH12X195</a>  | Switch Assembly              |
| 018 | A153528                 | <a href="#">153528</a>    | 8-32 X 1 2                   |
| 019 | A153012                 | <a href="#">153012</a>    | 8 Internal                   |
| 020 | A152001                 | <a href="#">152001</a>    | 8-32 X 3 8                   |
| 021 | A318711                 | <a href="#">318711</a>    | 320 330 43                   |
| 022 | A121060                 | <a href="#">121060</a>    | 5 8 Clear                    |
| 023 | A121492                 | <a href="#">121492</a>    | 3 16 Plas                    |
| 024 | A141225                 | <a href="#">141225</a>    | 19 7 16 S                    |
| 025 | A318700                 | <a href="#">W10146865</a> | SM Burner                    |
| 026 | A121491                 |                           | Not Available CLAMP (5/8")   |
| 027 | A319522                 | <a href="#">319522</a>    | 330 430 GA                   |
| 028 | A153528                 | <a href="#">153528</a>    | 8-32 X 1 2                   |
| 029 | A153012                 | <a href="#">153012</a>    | 8 Internal                   |
| 030 | A318009                 | <a href="#">W10146863</a> | 215 220 23                   |
| 031 | A151001                 | <a href="#">W10146764</a> | 8-32 Pal N                   |
| 032 | A141130                 | <a href="#">141130</a>    | Up-Shot GA                   |
| "   | <a href="#">A307122</a> |                           | V-Bracket                    |
| 033 | A128917                 |                           | Not Available IGNITER W/LEAD |
| 034 | A150315                 | <a href="#">150315</a>    | 6 X 3 8 P                    |
| 035 | A128918                 |                           | Not Available SENSOR, FLAME  |
| 036 | A121300                 | <a href="#">W10149174</a> | Open Close                   |
| 037 | A140810                 | <a href="#">140810</a>    | Burner Ori                   |
| "   | A140856                 | <a href="#">140856</a>    | Burner Ori                   |
| "   | A881936                 | <a href="#">W10148530</a> | Ad-435 L.p                   |

