

Maytag NAW2030A 07 - TRANSMISSION & RELATED PARTS (REV. F-K)

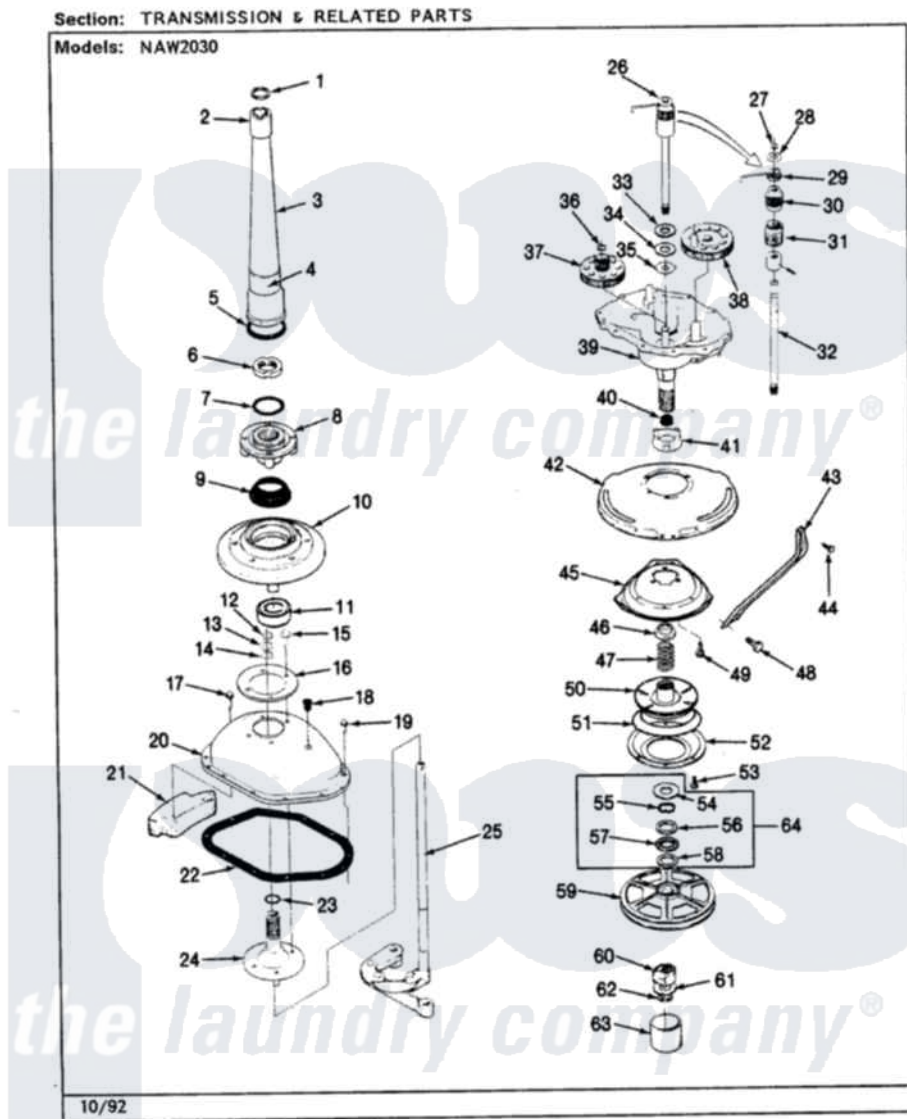

Maytag Residential Maytag NAW2030A Washer Parts Diagram 07 - TRANSMISSION & RELATED PARTS (REV. F-K)

Click on the part number to view part

Item	Original Part Number	Replaced By	Status	Part Description
1	LA-2175	35-6680		Transmission
"	35-3748	35-6680		Transmission
"	25-7941			"O" Ring, Agtr Drive Shaft
2	35-2835	21001066		Bearing, Centerpost
3	35-2792	21001401		Center Pos
4	33-6790			Bearing, Agitator
"	35-2983		Not Available	CENTERPOST ASSY.
5	35-2906			Seal, Centerpost Bottom
6	35-2791			Nut, Spin Tube
7	25-7938			"O" Ring, Basket Drive Hub
8	35-2715		Not Available	BASKET DRIVE HUB ASSY
"	35-3647	W10219156		Tub Seal
9	35-2974			Tub Seal/Hub Assembly
10	35-2716	12001561		Bearing And Seal Housing Assembly
11	35-2972	12001561		Bearing And Seal Housing

11		12001501	Assembly
"	35-2205		Bearing, Spin
12	25-7949		Not Available
			RING, RETAINING (AG. SHAFT)
13	25-7057		Washer, Flat
14	25-7051	25-7057	Washer, Flat
15	25-7895	21001858	Screw 5/16-18 x 1/2
16	35-2981		Cover, Reinforcement
17	25-7895	21001858	Screw 5/16-18 x 1/2
18	35-2621		Plug, Oil Fill
19	25-7926	25-7758	Screw
20	35-2971		Not Available
			TRANSMISSION COVER ASSY.
"	35-2620		Not Available
			COVER, TRANSMISSION
21	35-2903		Not Available
			COUNTERWEIGHT
22	35-1030		Not Available
			GASKET, TRANSMISSION HOUSING
23	25-7722	33-4293N	Gasket Kit
24	35-3702		Drive Tube Assembly
"	35-2708	35-3702	Drive Tube Assembly
25	35-3036	35-3804	Linkage Assembly
"	35-3804		Linkage Assembly
26	LA-2176		Not Available
			CLUTCH ASSY.
27	25-7847		Ring, Retaining
28	25-7415		Not Available
			WASHER, FLAT
"	25-7416		Not Available
			WASHER, FLAT
29	33-6114	33-6463	Spring
30	35-2001		Pinion, Drive
31	33-3195		Not Available
			SPRING
32	35-2692		Drive Shaft And Hub Assembly
33	25-7274		Not Available
			WASHER, STEEL
34	35-2817	35-3825	Washer, Nylon
35	35-2070		Washer, Steel W/Tab
36	25-7933		Ring, Retaining
37	35-2527		Gear, Cluster
38	35-2631		Not Available
			GEAR, CRANK
39	35-2812		Not Available
			HOUSING, TRANSMISSION
40	35-2010	207843	Lip Seal Repair Kit
41	35-2730	12001562	Bearing Assembly
"	35-2973	35-6680	Transmission
42	35-2732	21001518	Support, Tub
"	35-3724	21001518	Support, Tub
43	35-2798		Not Available
			TUB BRACE
44	25-7930	21001858	Screw 5/16-18 x 1/2
45	35-2015		Not Available
			SUSPENSION HOUSING
"	35-3698		Not Available
			HOUSING, SUSPENSION
46	35-2017		Retainer, Brake Spring
47	35-2112	21001910	Spring, Brake
48	25-7930	21001858	Screw 5/16-18 x 1/2
"	35-2025		Not Available
			PLATE, REINFORCEMENT
49	25-7895	21001858	Screw 5/16-18 x 1/2
50	35-2948	35-6714	Brake Roto
51	35-2357	21002026	Snubber

52	35-2018	35-6918		Stator, Brake
53	25-7900	21001065		Screw, No.10-24 x .50 Hxnibhd
54	W10124350		Not Available	NOT REQUIRED PART OR SEE NOTE NOT REQUIRED
55	W10124350		Not Available	NOT REQUIRED PART OR SEE NOTE NOT REQUIRED
56	W10124350		Not Available	NOT REQUIRED PART OR SEE NOTE NOT REQUIRED
57	W10124350		Not Available	NOT REQUIRED PART OR SEE NOTE NOT REQUIRED
58	W10124350		Not Available	NOT REQUIRED PART OR SEE NOTE NOT REQUIRED
59	35-2683	12002213		Thrust Bearing Kit
60	35-2439	12002213		Thrust Bearing Kit
61	35-2132			Washer, 1.25ODX.530IDX.032
"	35-2082			Washer, 1.25ODX.530IDX.062
62	25-7854			Ring, Retaining
63	35-2007			Cap, Dust
64	12500036	12002213		Thrust Bearing Kit

