

Maytag PAV1000GGE 05 - TRANSMISSION, DUAL DRIVE

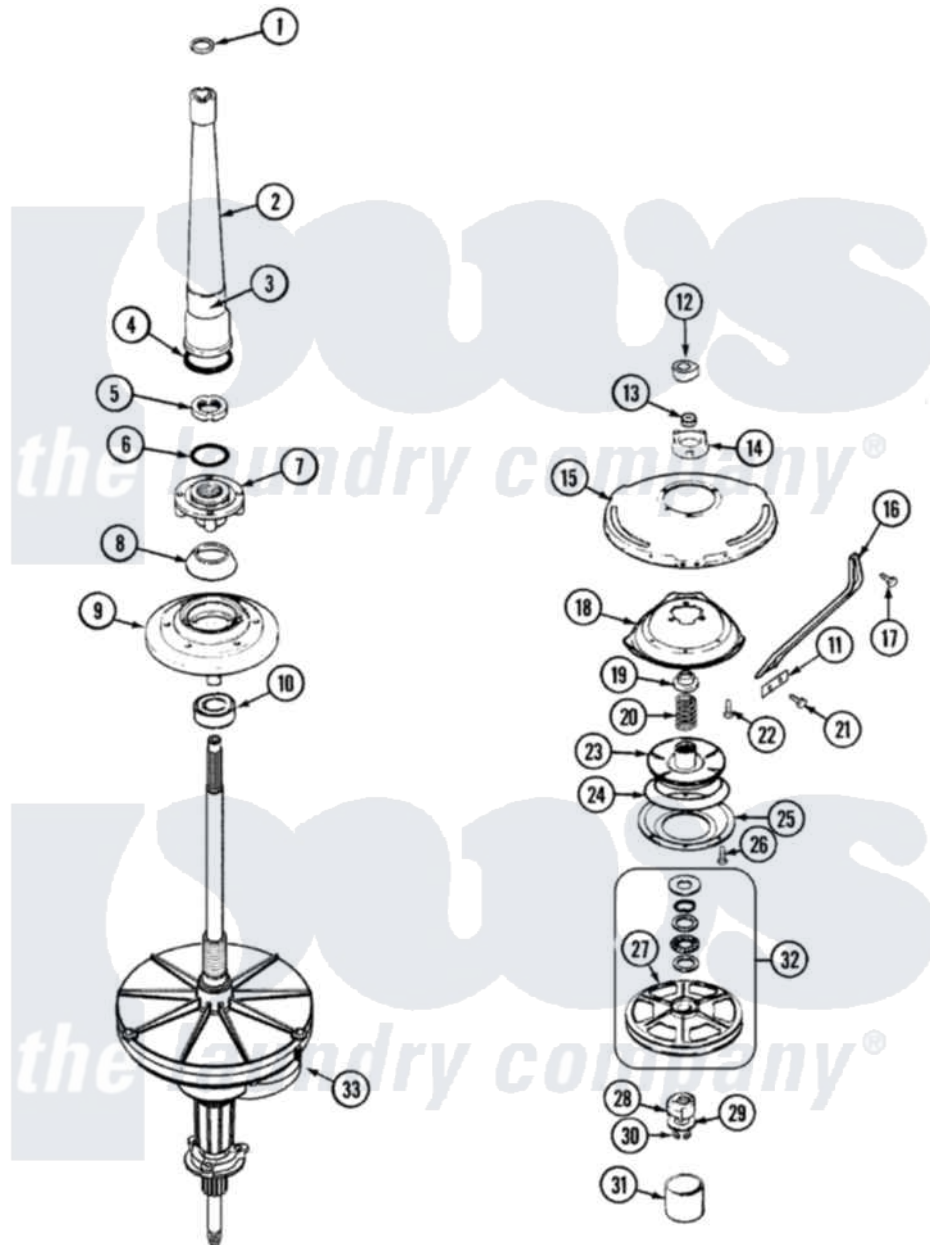

Maytag Residential Maytag PAV1000GGE Washer Parts Parts Diagram 05 - TRANSMISSION, DUAL DRIVE
 Click on the part number to view part

Item	Original Part Number	Replaced By	Status	Part Description
1	25-7941			"O" Ring, Agrtr Drive Shaft
2	35-2792	21001401		Center Pos
3	35-2983		Not Available	CENTERPOST ASSY.
"	33-6790			Bearing, Agitator
4	35-2906			Seal, Centerpost Bottom
5	35-2791			Nut, Spin Tube
6	25-7938			"O" Ring, Basket Drive Hub
7	35-3647	W10219156		Tub Seal
8	35-2974			Tub Seal/Hub Assembly
9	35-2716	12001561		Bearing And Seal Housing Assembly
10	35-2205			Bearing, Spin
"	12001561			Bearing And Seal Housing Assembly
11	35-2025		Not Available	PLATE, REINFORCEMENT
12	35-3384		Not Available	STOP, ANTIBACKUP CAM
13	35-2010	207843		Lip Seal Repair Kit

14	35-2973	35-6680	Transmission
"	12001562		Bearing Assembly
"	35-2730	12001562	Bearing Assembly
15	21001162	21001518	Support, Tub
16	21001164	Not Available	BRACE, TUB
17	25-7895	21001858	Screw 5/16-18 x 1/2
18	21001163		Housing, Suspension
19	35-2017		Retainer, Brake Spring
20	35-2112	21001910	Spring, Brake
21	25-7930	21001858	Screw 5/16-18 x 1/2
22	25-7895	21001858	Screw 5/16-18 x 1/2
23	35-2948	35-6714	Brake Roto
24	21001161	21002026	Snubber
25	35-2018	35-6918	Stator, Brake
26	21001065		Screw, No.10-24 x .50 Hxnibhd
27	35-3829	12002213	Thrust Bearing Kit
28	LA-2007	12002213	Thrust Bearing Kit
29	35-2132		Washer, 1.25ODX.530IDX.032
"	35-2082		Washer, 1.25ODX.530IDX.062
30	25-7854		Ring, Retaining
31	35-2007		Cap, Dust
32	12500036	12002213	Thrust Bearing Kit
33	21001394	35-6680	Transmission

the laundry company[®]

the laundry company[®]