

Maytag SG1000 10 - INLET DUCT & HEATER ASSEMBLY (SE1000)

SECTION: INLET DUCT & HEATER ASSEMBLY
 MODEL: SE-S61000

P/N 56287R1

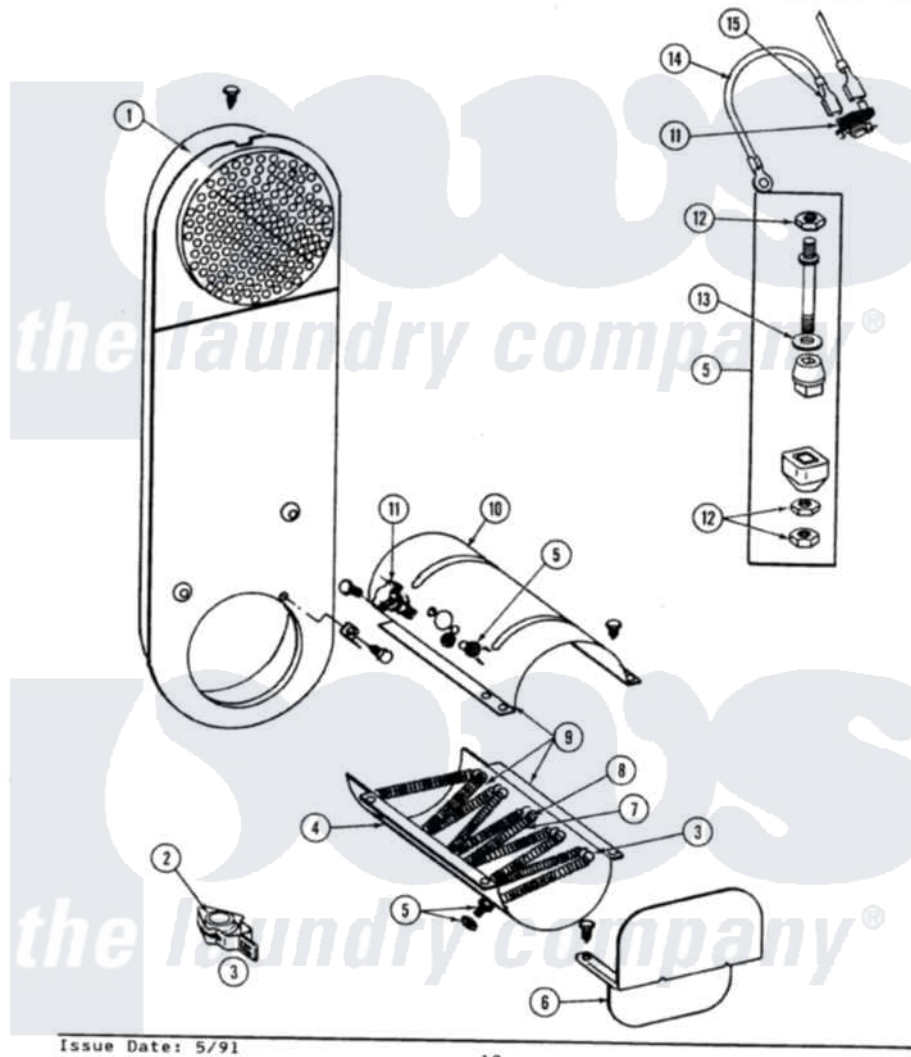

Issue Date: 5/91

18

Maytag Residential Maytag SG1000 Stacked Washer and Dryer Parts Parts Diagram 10 - INLET DUCT & HEATER ASSEMBLY (SE1000)

[Click on the part number to view part](#)

Item	Original Part Number	Replaced By	Status	Part Description
2	Y313270			Insulator For Heater Elemen
3	Y303881			Clip And Insulator Assembly
4	314501			Heater Enclosure-Bottom
"	211294	90767		Screw, 8A X 3/8 HeX Washer Head Tapping
5	Y304596			Terminal Insulator Assembly
6	211294	90767		Screw, 8A X 3/8 HeX Washer Head Tapping
"	314504			Radiant Shield
7	314503			Heater Coil 240 Volt
8	306378		Not Available	HEATING ELEMENT KIT - 208V
9	Y306379		Not Available	HEATER ASSM. COMPLETE - 208
"	Y306111			Heater Assembly Complete
10	314502			Heater Enclosure-Top
11	303896			Hi-Limit Thermostat-Canada

"	303396		Thermostat, Hi-Limit
"	211294	90767	Screw, 8A X 3/8 HeX Washer Head Tapping
12	311484	112432	Nut

