

# Maytag SG1000 14 - MOTOR & IDLER ASSEMBLY

SECTION: MOTOR & IDLER ASSEMBLY  
 MODEL: SE-SG1000

P/N 56287R1

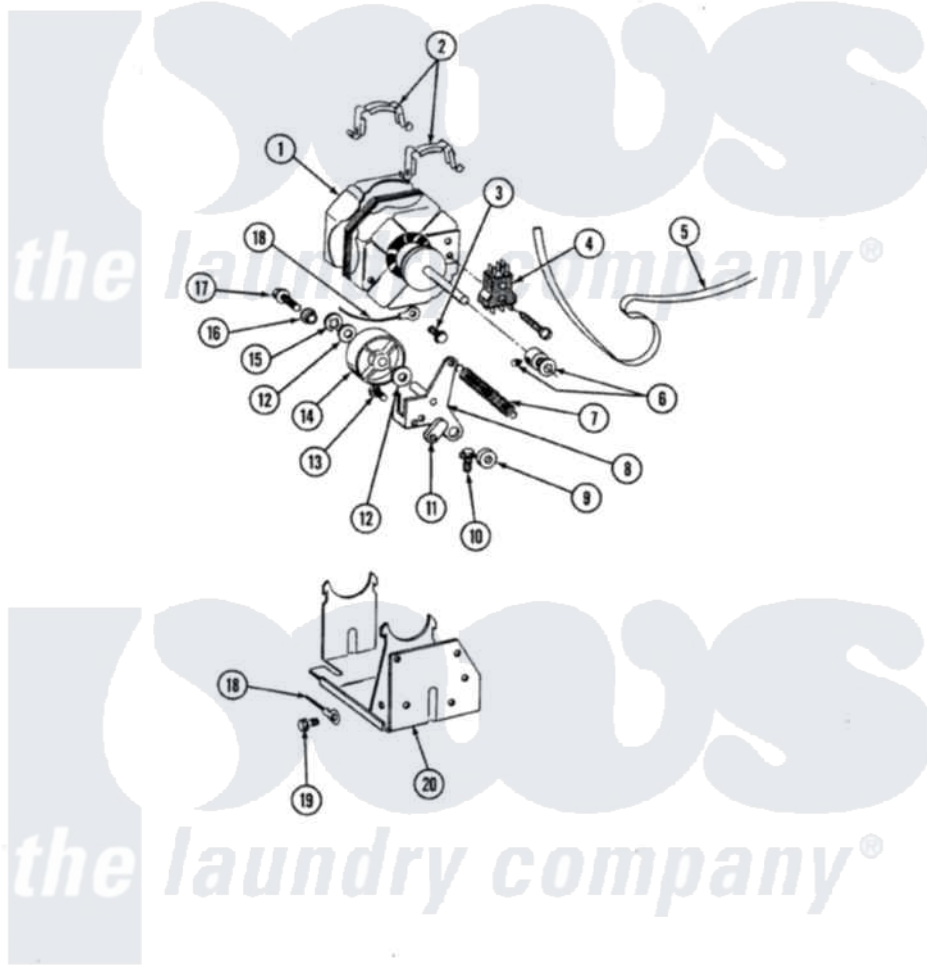

Issue Date: 5/91

14

Maytag Residential Maytag SG1000 Stacked Washer and Dryer Parts Parts Diagram 14 - MOTOR & IDLER ASSEMBLY  
 Click on the part number to view part

Item	Original Part Number	Replaced By	Status	Part Description
1	306055	<a href="#">W10411000</a>		Motor-Drve
2	<a href="#">Y015825</a>			Clip, Motor To Motor Support
3	211294	<a href="#">90767</a>		Screw, 8A X 3/8 HeX Washer Head Tapping
4	Y303877		Not Available	SWITCH, MOTOR EXTERNAL START No.303358-2, No.303358-4, 303358-7
"	306207		Not Available	(PROD. No.303358-8 & No.303358-9)
5	314774	<a href="#">Y312959</a>		Poly "V" Belt For Tumbler
6	<a href="#">Y053241</a>			Set Screw, Motor Pulley
"	<a href="#">306099</a>			Motor Pulley With Set Screw
7	<a href="#">314473</a>			Spring For Idler
8	Y303363	<a href="#">6-3033630</a>		Idler Arm
9	<a href="#">314457</a>			Spacer For Idler Arm
10	<a href="#">Y313561</a>			Screw----NA
11	<a href="#">314456</a>			Spacer
12	<a href="#">Y312527</a>			Washer, Idler Shaft

13	Y312057	<a href="#">910624</a>	Screw
14	Y303705	<a href="#">6-3037050</a>	Pulley- ID
15	312958	<a href="#">354987</a>	Ring, Retaining
16	Y312894	<a href="#">315772</a>	Sleeve, Idler Arm
17	Y310842	<a href="#">8182296</a>	Screw, Agitator
18	<a href="#">901220</a>		Ground Wire
19	211294	<a href="#">90767</a>	Screw, 8A X 3/8 HeX Washer Head Tapping
20	<a href="#">306054</a>		Support, Motor

