

Norge DEL263A 03 - CYLINDER & DRIVE (REV.A-D)

SECTION: CYLINDER & DRIVE
 MODEL: DEL263

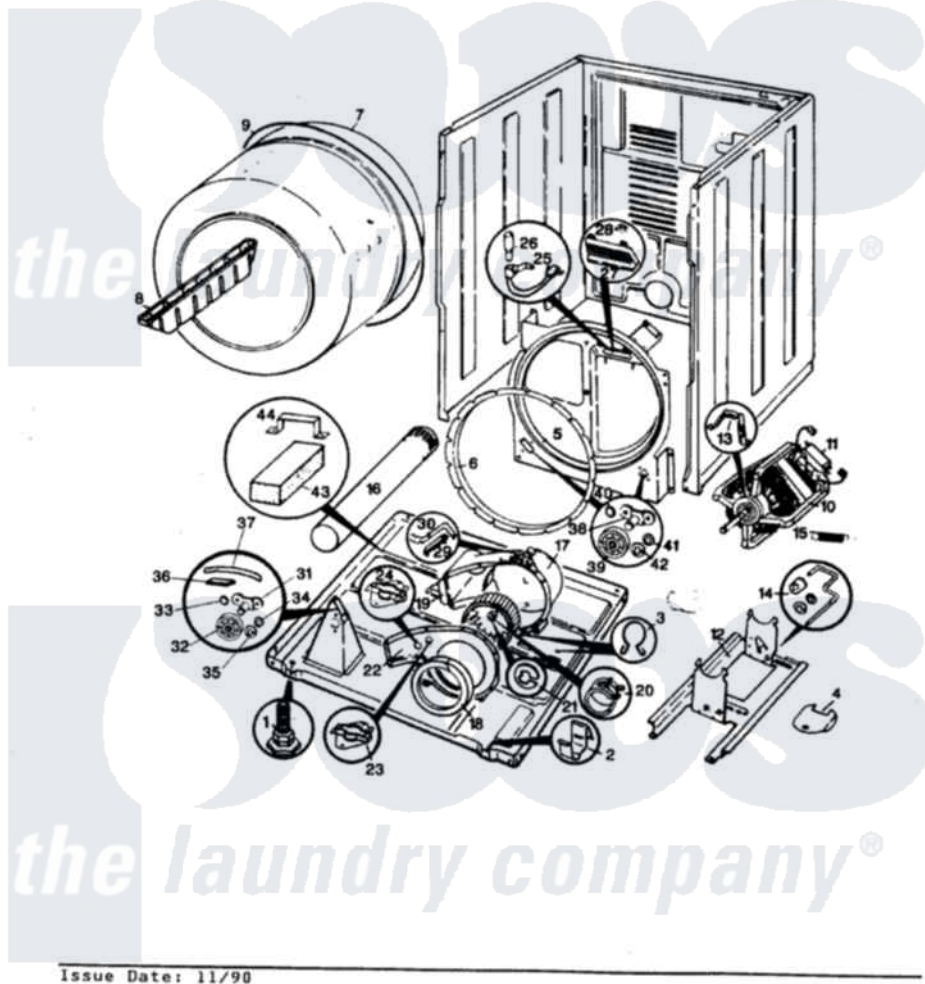

Issue Date: 11/90

Norge Residential Norge DEL263A Dryer Parts Parts Diagram 03 - CYLINDER & DRIVE (REV.A-D)
 Click on the part number to view part

Item	Original Part Number	Replaced By	Status	Part Description
1	63-5519		Not Available	LEG, LEVELING
2	53-0120			Clip, Front Panel
3	25-7027	16515		Clip
4	25-7741	W10116760		Screw
"	53-0153		Not Available	SHIELD, WIRING
5	53-0131	LA-1054		Dryer Bulkhead Kit
"	25-7732	681414		Screw, 10AB X 1/2
6	53-0282	31001637		Seal Assembly, Cylinder Front
7	53-0178	53-1250		Cylinder
8	53-0117		Not Available	BAFFLE, GRAY
"	25-7759	3196164		Screw
9	53-1080	341241		Belt
10	53-1042			Motor Assembly 230V/60Hz
11	53-0693	53-0332		Motor Switch
12	53-0852		Not Available	MOTOR BRACKET
"	25-7811		Not Available	SCREW

13	25-7674		Screw
"	53-0214	660658	Clamp, Motor Mounting 343481 685441
14	53-1628	31001344	Pulley, Idler
"	53-1650		Not Available IDLER ASSY
"	53-0764	53-2366	Idler Arm
15	53-1548		Timer
"	53-0207		Not Available IDLER SPRING
16	53-0134		Duct, Exhaust
"	25-2134	W10116760	Screw
17	53-0774		Not Available BLOWER HOUSING
18	53-0203	12001324	Duct Kit, Collector
19	53-0106		Blower Wheel
20	25-7823	312967	Clamp, Blower Housing
21	25-7855		Ring, Retaining
22	25-7807	33002917	Screw, No.10-16
"	25-3457		Screw, Sems
"	53-1026		Guide, Vane Inlet
"	53-1024		Not Available BLOWER COVER
23	53-1107		Thermostat, Control
24	25-2134	W10116760	Screw
"	53-0170		Not Available THERMOSTAT, LO-LIMIT (120/110)
25	W10124350		Not Available NOT REQUIRED PART OR SEE NOTE NOT REQUIRED
26	W10124350		Not Available NOT REQUIRED PART OR SEE NOTE NOT REQUIRED
27	W10124350		Not Available NOT REQUIRED PART OR SEE NOTE NOT REQUIRED
28	W10124350		Not Available NOT REQUIRED PART OR SEE NOTE NOT REQUIRED
"	LA-1006		Glide Kit, Tumbler
29	53-0182	31001356	Pad, Glide
30	53-0183	31001469	Glide, Tumbler
31	W10124350		Not Available NOT REQUIRED PART OR SEE NOTE NOT REQUIRED
32	LA-1007	12002126	Reinforcement Brace/Glide Kit
33	25-7813		Spacer
34	25-7814		Washer
35	25-7854		Ring, Retaining
36	53-0723	31001356	Pad, Glide
37	53-0185	31001470	Glide, Tumbler
"	LA-1008		Rr Roller Kit
38	53-0198		Support Assembly
"	25-7101	3351614	Screw, Gearcase Cover Mounting
39	53-0642	31001096	Roller
40	25-7813		Spacer
41	25-7814		Washer
42	25-7854		Ring, Retaining
43	W10124350		Not Available NOT REQUIRED PART OR SEE NOTE NOT REQUIRED
44	W10124350		Not Available NOT REQUIRED PART OR SEE NOTE NOT REQUIRED
NI	63-5577		Not Available MANUAL, USE & CARE
45	53-1452-1		Not Available MANUAL, USE & CARE
"	53-1452		Not Available MANUAL, USE & CARE

