

Norge DGJ181W 02 - CYLINDER & DRIVE (ORIG.-REV.A)

NORGE DGJ18-1 CYLINDER & DRIVE

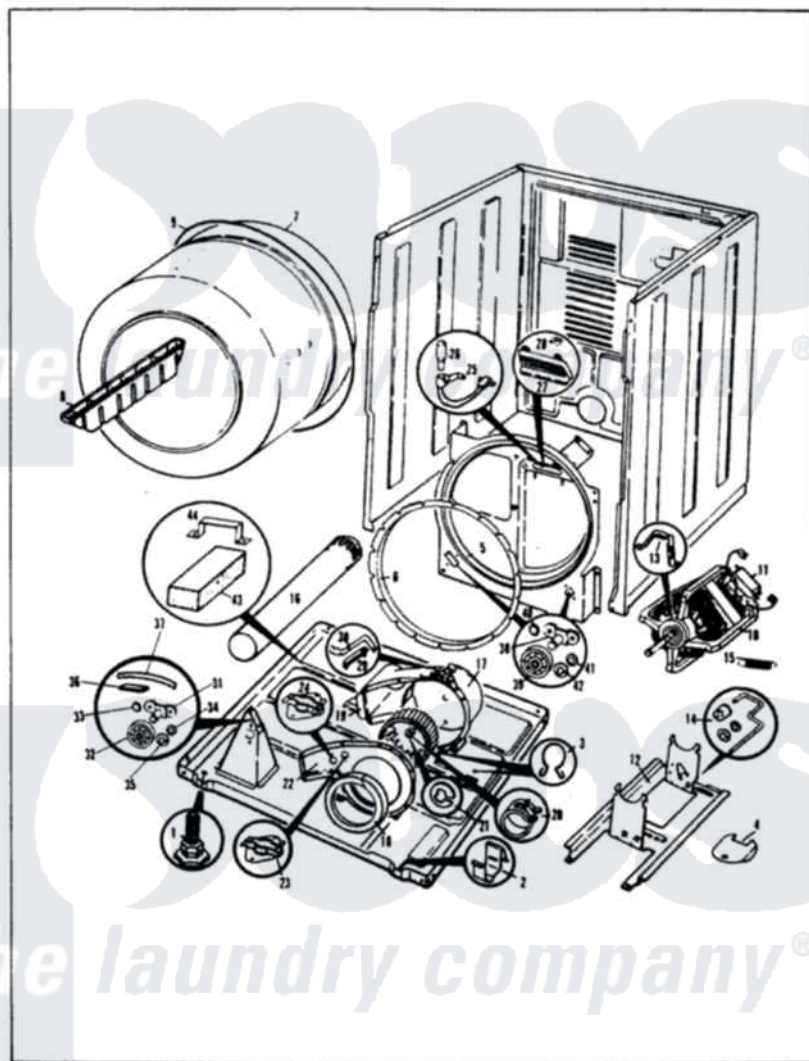

ISSUED 4/88

Norge [Residential Norge DGJ181W Dryer Parts](#) Parts Diagram 02 - CYLINDER & DRIVE (ORIG.-REV.A)

[Click on the part number to view part](#)

| Item | Original Part Number | Replaced By | Status | Part Description |
|------|-------------------------|---------------------------|---------------|-------------------------------|
| 1 | 63-5519 | | Not Available | LEG, LEVELING |
| 2 | 53-0120 | | | Clip, Front Panel |
| 3 | 25-7027 | 16515 | | Clip |
| 4 | 53-0153 | | Not Available | SHIELD, WIRING |
| " | 25-7741 | W10116760 | | Screw |
| 5 | 25-7733 | 681414 | | Screw, 10AB X 1/2 |
| " | 53-0131 | LA-1054 | | Dryer Bulkhead Kit |
| 6 | 53-0282 | 31001637 | | Seal Assembly, Cylinder Front |
| 7 | 53-0178 | 53-1250 | | Cylinder |
| 8 | 25-7759 | 3196164 | | Screw |
| " | 53-0117 | | Not Available | BAFFLE, GRAY |
| 9 | 53-0186 | 341241 | | Belt |
| " | LA-1004 | | | Motor Mtg. Kit |
| 10 | 53-1041 | LA-1004 | | Motor Mtg. Kit |
| 11 | 73-0467 | | Not Available | MOTOR SWITCH |
| " | 53-0332 | | | Motor Switch |

| | | | | |
|----|-------------------------|---------------------------|---------------|--|
| 12 | 53-0852 | | Not Available | MOTOR BRACKET |
| " | 25-7811 | | Not Available | SCREW |
| 13 | 25-7674 | | | Screw |
| " | 53-0214 | 660658 | | Clamp, Motor Mounting 343481 685441 |
| 14 | 53-0764 | 53-2366 | | Idler Arm |
| 15 | 53-0207 | | Not Available | IDLER SPRING |
| 16 | 25-2134 | W10116760 | | Screw |
| " | 53-0134 | | | Duct, Exhaust |
| 17 | 53-0774 | | Not Available | BLOWER HOUSING |
| 18 | 53-0203 | 12001324 | | Duct Kit, Collector |
| " | 53-0704 | LA-1050 | | Blower Cover And Vane Kit |
| 19 | 53-0106 | | | Blower Wheel |
| 20 | 25-7823 | 312967 | | Clamp, Blower Housing |
| 21 | 25-7855 | | | Ring, Retaining |
| 22 | 53-1026 | | | Guide, Vane Inlet |
| " | 53-1023 | | | Blower Cover |
| " | 53-0751 | LA-1050 | | Blower Cover And Vane Kit |
| " | 25-2134 | W10116760 | | Screw |
| " | 25-7807 | 33002917 | | Screw, No.10-16 |
| 23 | 53-0263 | 53-1107 | | Thermostat, Control |
| 24 | W10124350 | | Not Available | NOT REQUIRED PART OR SEE NOTE |
| " | 25-2134 | W10116760 | | Screw |
| 25 | W10124350 | | Not Available | NOT REQUIRED PART OR SEE NOTE |
| 26 | W10124350 | | Not Available | NOT REQUIRED PART OR SEE NOTE |
| 27 | W10124350 | | Not Available | NOT REQUIRED PART OR SEE NOTE |
| 28 | W10124350 | | Not Available | NOT REQUIRED PART OR SEE NOTE |
| " | LA-1006 | | | Glide Kit, Tumbler |
| 29 | 53-0182 | 31001356 | | Pad, Glide |
| 30 | 53-0183 | 31001469 | | Glide, Tumbler |
| 31 | W10124350 | | Not Available | NOT REQUIRED PART OR SEE NOTE |
| 32 | W10124350 | | Not Available | NOT REQUIRED PART OR SEE NOTE |
| 33 | W10124350 | | Not Available | NOT REQUIRED PART OR SEE NOTE |
| 34 | W10124350 | | Not Available | NOT REQUIRED PART OR SEE NOTE |
| 35 | W10124350 | | Not Available | NOT REQUIRED PART OR SEE NOTE |
| 36 | 53-0723 | 31001356 | | Pad, Glide |
| 37 | LA-1008 | | | Rr Roller Kit |
| " | 53-0185 | 31001470 | | Glide, Tumbler |
| 38 | 53-0197 | | | Support Assembly-Cylinder Rear |
| " | 25-7101 | 3351614 | | Screw, Gearcase Cover Mounting |
| 39 | 53-0642 | 31001096 | | Roller |
| 40 | 25-7813 | | | Spacer |
| 41 | 25-7814 | | | Washer |
| 42 | 25-7854 | | | Ring, Retaining |
| 43 | 53-0645 | | Not Available | COUNTERWEIGHT |
| 44 | 53-0644 | | Not Available | BRACKET |

