

# Norge LWL203H 01 - BASE & DRIVE (REV. A-D)

NORGE LWL203 BASE & DRIVE

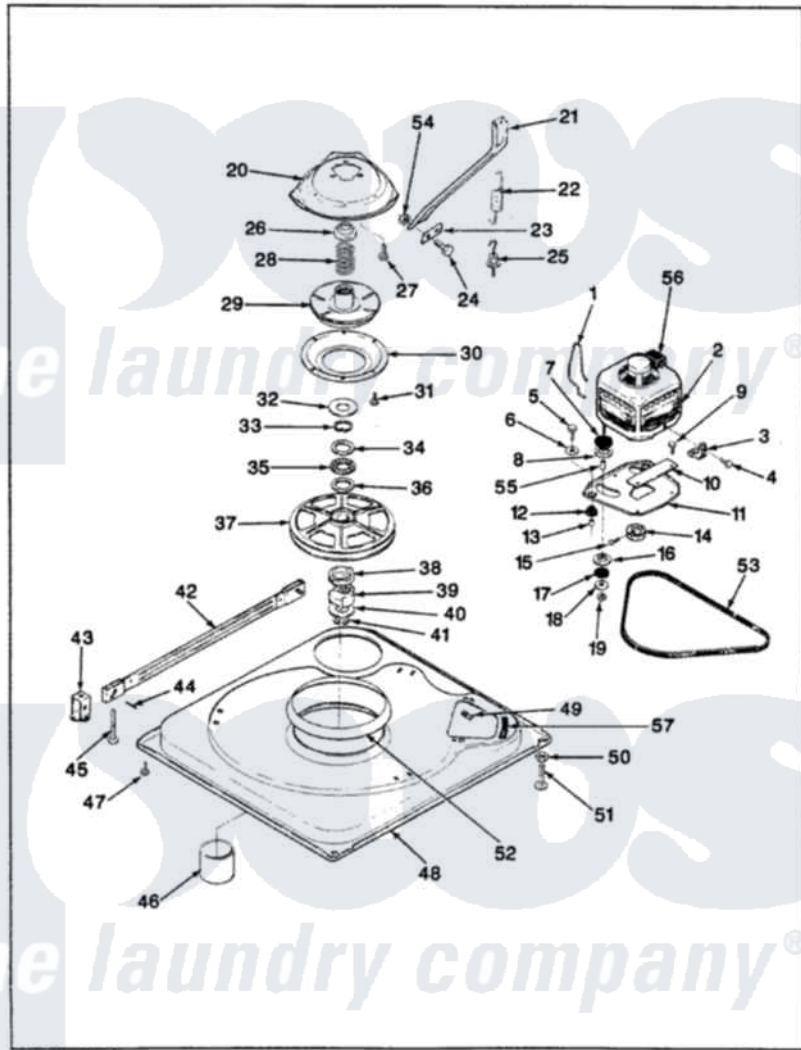

ISSUED 9/89

Norge Residential Norge LWL203H Washer Parts Parts Diagram 01 - BASE & DRIVE (REV. A-D)  
 Click on the part number to view part

Item	Original Part Number	Replaced By	Status	Part Description
1	<a href="#">35-0235</a>			Spring, Motor Pivot
2	35-2030		Not Available	MOTOR
"	LA-2002		Not Available	MOTOR KIT
3	<a href="#">33-9945</a>			Slide, Foot
4	25-7418	<a href="#">33001178</a>		Back, Tumbler
5	25-7833	<a href="#">21001977</a>		Screw
6	<a href="#">25-7834</a>			Washer, Motor/Base Screw
7	<a href="#">33-9946</a>			Isolator, Motor
8	33-9944	<a href="#">35-3570</a>		Washer, Motor Pivot
9	25-3083	<a href="#">212951</a>		Screw, No.6-32 X 1/4 Inch
10	33-9947		Not Available	DBL.PIVOT SLIDE
11	35-2021	<a href="#">21001783</a>		Plate And Screw Assembly
12	33-9941	<a href="#">35-3646</a>		Isolator, Motor Plate
13	<a href="#">25-7831</a>			Spacer, Mounting
14	35-2124	<a href="#">W10143344</a>		Pulley
15	<a href="#">25-7117</a>			Set Screw

16	33-9943	<a href="#">35-3571</a>		Slide, Motor Pivot
17	<a href="#">33-9967</a>			Washer, Motor Isolator
18	<a href="#">25-7047</a>			Washer, Flat
19	25-7325	<a href="#">Y707702</a>		Locknut
20	35-2015		Not Available	SUSPENSION HOUSING
21	<a href="#">35-2024</a>			Brace, Tub
"	25-7930	<a href="#">21001858</a>		Screw 5/16-18 x 1/2
"	35-2531		Not Available	BRACE, TUB
22	35-2092		Not Available	SUSPENSION SPRING
23	35-2025		Not Available	PLATE, REINFORCEMENT
24	<a href="#">25-7912</a>			Screw
25	<a href="#">25-7365</a>			Eye Bolt
26	<a href="#">35-2017</a>			Retainer, Brake Spring
27	25-7895	<a href="#">21001858</a>		Screw 5/16-18 x 1/2
28	35-2112	<a href="#">21001910</a>		Spring, Brake
29	35-2113	<a href="#">35-6714</a>		Brake Roto
30	35-2018	<a href="#">35-6918</a>		Stator, Brake
31	<a href="#">25-7359</a>			Screw
32	35-2016		Not Available	SPACER-BEARING
33	<a href="#">25-7909</a>			Washer
34	35-2318		Not Available	WASHER
35	35-2078	<a href="#">12002213</a>		Thrust Bearing Kit
36	35-2081	<a href="#">35-3456</a>		Washer
37	35-2119	<a href="#">12002213</a>		Thrust Bearing Kit
38	35-2441	<a href="#">12002213</a>		Thrust Bearing Kit
39	35-2439	<a href="#">12002213</a>		Thrust Bearing Kit
40	<a href="#">35-2082</a>			Washer, 1.25ODX.530IDX.062
41	<a href="#">25-7854</a>			Ring, Retaining
42	35-2049	<a href="#">21001881</a>		Bar, Stabilizer
43	<a href="#">35-2046</a>			Bracket, Stabilizer
44	<a href="#">35-2052</a>			Pin, Stabilizer
45	35-2050	<a href="#">22004469</a>		Leg And Foot Self Stabalizing
"	35-2039		Not Available	PAD, FOOT
46	<a href="#">35-2007</a>			Cap, Dust
47	25-7828	<a href="#">489483</a>		Screw 10-32 X 1/2
48	35-2019		Not Available	BASE, WASHER
49	25-7838	<a href="#">25-7845</a>		Speednut, Motor
50	<a href="#">25-7915</a>			Hex Nut
51	35-0837	<a href="#">25001119</a>		Foot And Pad Assembly
"	35-0772	<a href="#">25001119</a>		Foot And Pad Assembly
52	35-2357	<a href="#">21002026</a>		Snubber
53	35-2320	<a href="#">21352320</a>		Belt, Drive
54	25-0226		Not Available	HEX NUT
55	<a href="#">25-7830</a>			Spacer
56	<a href="#">33-9765</a>			Switch, Motor
"	25-7413		Not Available	FLAT WASHER
57	<a href="#">35-2065</a>			Pad, Motor Plate
58	35-2329		Not Available	REINF TUB SUPPORT
59	25-7910	<a href="#">25-7758</a>		Screw
60	25-7037		Not Available	KEPS NUT