

Norge LWM204A 13 - TRANSMISSION & RELATED PARTS (REV. G-L)

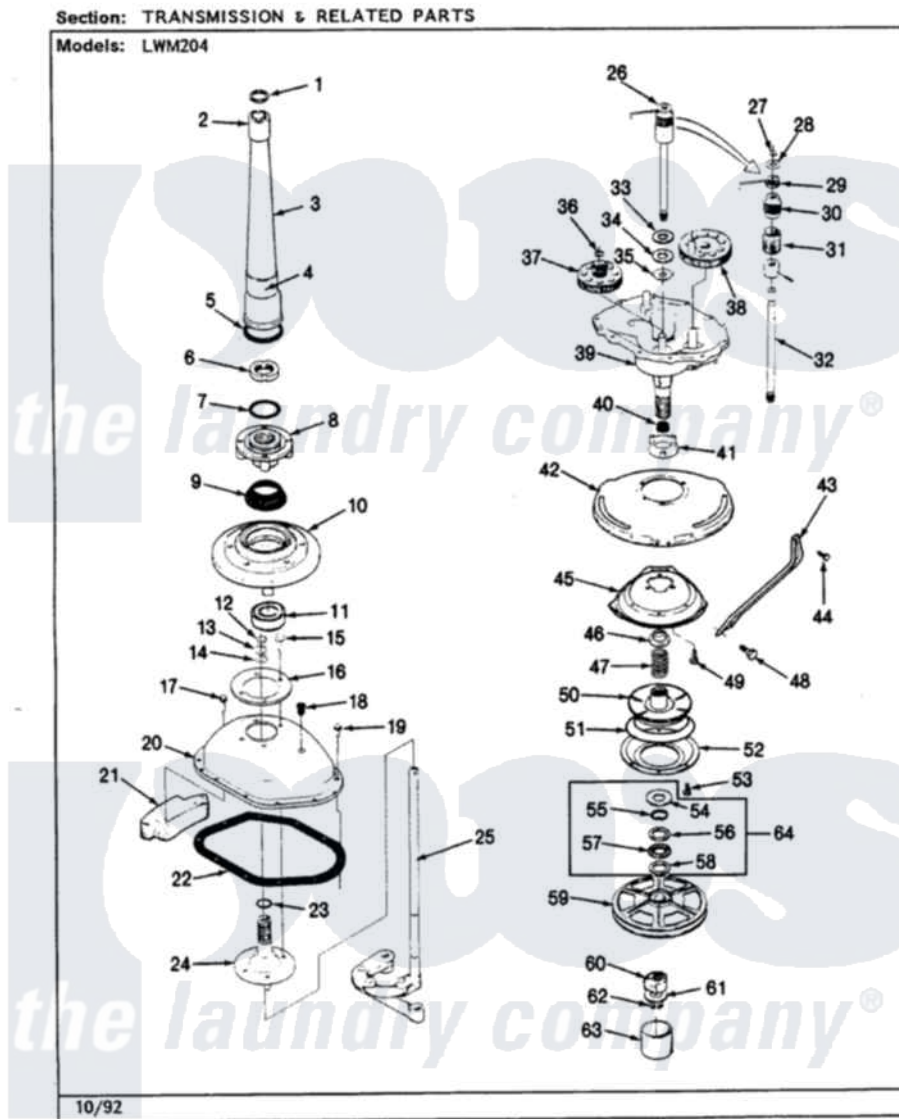

Norge Residential Norge LWM204A Washer Parts Parts Diagram 13 - TRANSMISSION & RELATED PARTS (REV. G-L)
Click on the part number to view part

Item	Original Part Number	Replaced By	Status	Part Description
1	25-7941			"O" Ring, Agr Drive Shaft
2	35-2835	21001066		Bearing, Centerpost
3	35-2792	21001401		Center Pos
4	33-6790			Bearing, Agitator
"	35-2983		Not Available	CENTERPOST ASSY.
5	35-2906			Seal, Centerpost Bottom
6	35-2791			Nut, Spin Tube
7	25-7938			"O" Ring, Basket Drive Hub
8	35-3647	W10219156		Tub Seal
"	35-2715		Not Available	BASKET DRIVE HUB ASSY
9	35-2974			Tub Seal/Hub Assembly
10	35-2716	12001561		Bearing And Seal Housing Assembly
11	35-2972	12001561		Bearing And Seal Housing Assembly
"	35-2205			Bearing, Spin
12	25-7940		Not Available	RING, RETAINING (AG.

		Not Available	SHAFT)
13	25-7057		Washer, Flat
14	25-7051	25-7057	Washer, Flat
15	25-7895	21001858	Screw 5/16-18 x 1/2
16	35-2981		Cover, Reinforcement
17	25-7895	21001858	Screw 5/16-18 x 1/2
18	35-2621		Plug, Oil Fill
19	25-7926	25-7758	Screw
20	35-2971	Not Available	TRANSMISSION COVER ASSY.
"	35-2620	Not Available	COVER, TRANSMISSION
21	35-2903	Not Available	COUNTERWEIGHT
22	35-1030	Not Available	GASKET, TRANSMISSION HOUSING
23	25-7722	33-4293N	Gasket Kit
24	35-2708	35-3702	Drive Tube Assembly
"	35-3702		Drive Tube Assembly
25	35-3804		Linkage Assembly
"	35-3036	35-3804	Linkage Assembly
26	LA-2176	Not Available	CLUTCH ASSY.
27	25-7847		Ring, Retaining
28	25-7416	Not Available	WASHER, FLAT
"	25-7415	Not Available	WASHER, FLAT
29	33-6114	33-6463	Spring
30	35-2001		Pinion, Drive
31	33-3195	Not Available	SPRING
32	35-2692		Drive Shaft And Hub Assembly
33	25-7274	Not Available	WASHER, STEEL
34	35-2817	35-3825	Washer, Nylon
35	35-2070		Washer, Steel W/Tabs
36	25-7933		Ring, Retaining
37	35-2527		Gear, Cluster
38	35-2631	Not Available	GEAR, CRANK
39	35-2812	Not Available	HOUSING, TRANSMISSION
40	35-2010	207843	Lip Seal Repair Kit
41	35-2973	35-6680	Transmission
"	35-2730	12001562	Bearing Assembly
42	35-3724	21001518	Support, Tub
"	35-2732	21001518	Support, Tub
43	35-2798	Not Available	TUB BRACE
44	25-7930	21001858	Screw 5/16-18 x 1/2
45	35-2015	Not Available	SUSPENSION HOUSING
"	35-3698	Not Available	HOUSING, SUSPENSION
46	35-2017		Retainer, Brake Spring
47	35-2112	21001910	Spring, Brake
48	35-2025	Not Available	PLATE, REINFORCEMENT
"	25-7930	21001858	Screw 5/16-18 x 1/2
49	25-7895	21001858	Screw 5/16-18 x 1/2
50	35-2948	35-6714	Brake Roto
51	35-2357	21002026	Snubber
52	35-2018	35-6918	Stator, Brake
53	25-7900	21001065	Screw, No.10-24 x .50 Hxnibhd

NOT REQUIRED PART OR

54	W10124350		Not Available	SEE NOTE SPACER, BEARING
55	W10124350		Not Available	NOT REQUIRED PART OR SEE NOTE WASHER, SPRING (CURVED)
56	W10124350		Not Available	NOT REQUIRED PART OR SEE NOTE WASHER, RACE (UPPER)
57	W10124350		Not Available	NOT REQUIRED PART OR SEE NOTE BEARING, THRUST
58	W10124350		Not Available	NOT REQUIRED PART OR SEE NOTE WASHER, RACE (LOWER)
59	35-2683	12002213		Thrust Bearing Kit
60	35-2439	12002213		Thrust Bearing Kit
61	35-2132			Washer, 1.25ODX.530IDX.032
"	35-2082			Washer, 1.25ODX.530IDX.062
62	25-7854			Ring, Retaining
63	35-2007			Cap, Dust
64	12500036	12002213		Thrust Bearing Kit
"	35-3748	35-6680		Transmission
"	LA-2175	35-6680		Transmission

