

# Whirlpool 4GWTW4800YQ0 04 - GEARCASE, MOTOR AND PUMP PARTS

## GEARCASE, MOTOR AND PUMP PARTS

For Model: 4GWTW4800YQ0  
(White)

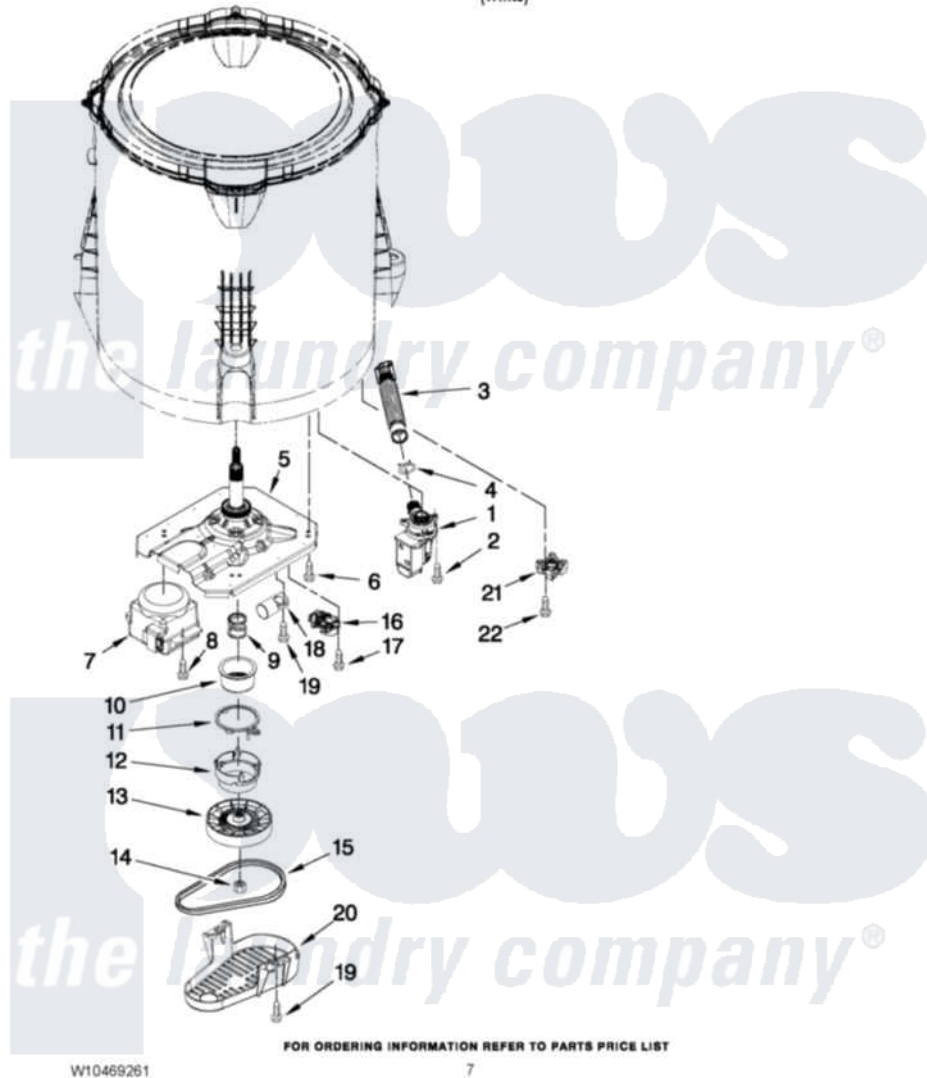

Whirlpool Residential Whirlpool 4GWTW4800YQ0 Washer Parts Parts Diagram 04 - GEARCASE, MOTOR AND PUMP PARTS

[Click on the part number to view part](#)

Item	Original Part Number	Replaced By	Status	Part Description
1	<a href="#">W10297344</a>			Pump Assembly, Drain
2	<a href="#">W10004910</a>			Screw, 12-16 X 1-1/4
3	<a href="#">W10215091</a>			Hose, Inner Drain Assembly
4	8317496	<a href="#">285655</a>		Clamp, Hose
5	W10006378	<a href="#">W10473144</a>		Gearcase Assembly
6	<a href="#">W10249633</a>			Screw, 7.2-1.6 X 30
7	<a href="#">W10249626</a>			Motor, Drive
8	W10094780	<a href="#">W10182109</a>		Screw-Kit
9	W10006382	<a href="#">W10315818</a>		Cam
10	W10006352	<a href="#">W10315818</a>		Cam
11	W10006353	<a href="#">W10315818</a>		Cam
12	W10006354	<a href="#">W10315818</a>		Cam
13	<a href="#">W10006356</a>			Pulley
14	<a href="#">W10163336</a>			Nut, Pulley
15	<a href="#">W10006384</a>			Belt, Drive
16	<a href="#">W10249623</a>			Actuator, Shift

17	<a href="#">9741052</a>	Screw, 6-32 X 1.00
18	<a href="#">W10349182</a>	Capacitor, Motor Run
19	<a href="#">357640</a>	Screw And Washer
20	<a href="#">W10006383</a>	Shield, Pulley Cover
21	<a href="#">W10238318</a>	Counterweight
22	<a href="#">W10238319</a>	Screw, 8-18 X 1.00

