

Whirlpool WED7990XG0 01 - TOP AND CONSOLE PARTS



TOP AND CONSOLE PARTS

For Model: WED7990XG0
(Cosmetallic)

29" ELECTRIC DRYER

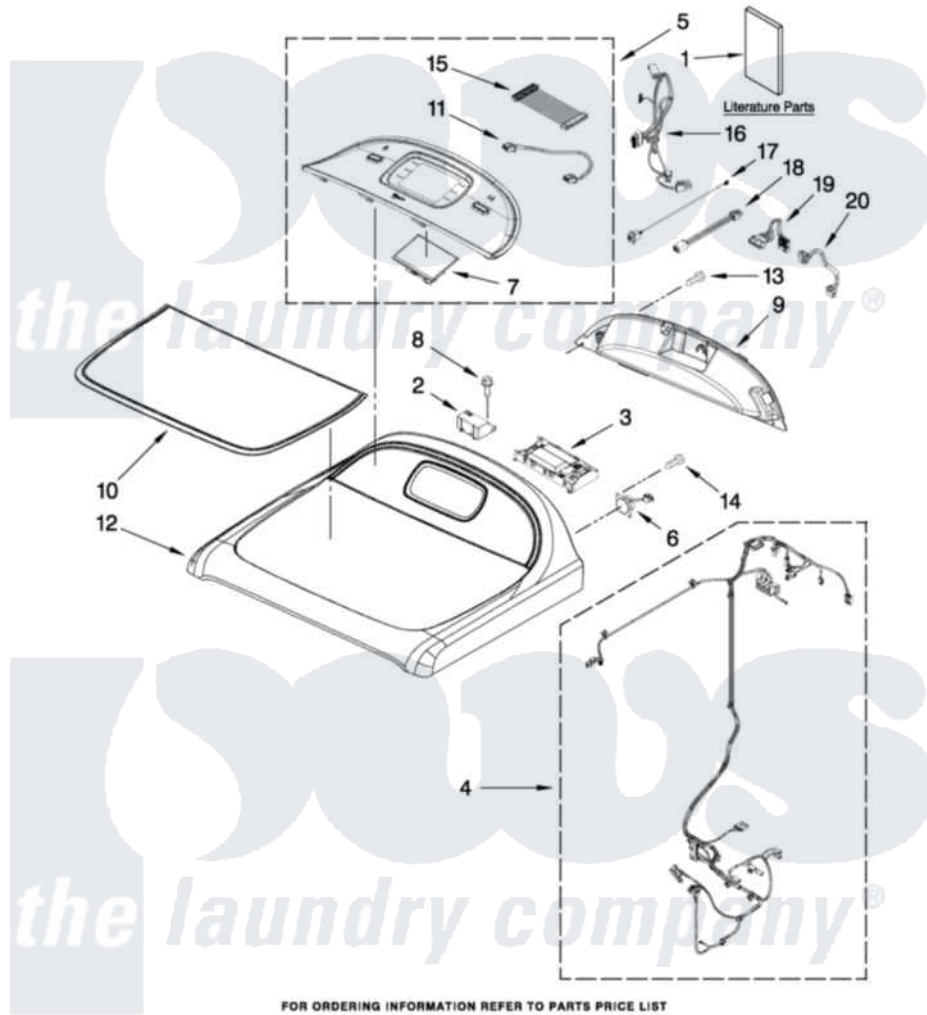

FOR ORDERING INFORMATION REFER TO PARTS PRICE LIST

8-10 Litho in U.S.A. (LT) (eeb)

1

Part No. W10313470 Rev. A

Whirlpool [Residential Whirlpool WED7990XG0 Dryer Parts](#) Parts Diagram 01 - TOP AND CONSOLE PARTS
Click on the part number to view part

| Item | Original Part Number | Replaced By | Status | Part Description |
|------|---------------------------|---------------------------|---------------|-----------------------------------|
| 1 | W10304462 | | Not Available | TECH SHEET |
| " | W10309054 | | Not Available | GUIDE, USE & CARE |
| " | W10309144 | | Not Available | GUIDE, QUICK START |
| " | W10309063 | | Not Available | INSTALLATION, DIAGNOSTIC GUIDE |
| 2 | W10286070 | W10330449 | | Control, Electronic |
| 3 | W10280594 | | | Supply, Power |
| 4 | W10280756 | | | Harness, Main |
| 5 | W10285783 | | | Console, Fascia Assembly |
| 6 | W10280595 | | | Assembly, Speaker |
| 7 | W10280744 | | | Lcd Assembly User Interface |
| 8 | 12990204 | M0238331 | | Screw |
| 9 | W10285812 | | | Panel, Rear Console |
| 10 | W10285802 | | | Assembly, Panel |
| 11 | W10289382 | | | Jumper, Atlas Audio To Hmi |
| 12 | W10285773 | | | Top And Console Assembly |
| 13 | 3390647 | 488729 | | Screw |

| | | |
|----|---------------------------|--------------------------------|
| 14 | W10300815 | Screw, M2-0.89 X 10 |
| 15 | W10167482 | Wire Assembly, Main Connection |
| 16 | W10280738 | Jumper, User Interface |
| 17 | W10280760 | Jumper, User Interface |
| 18 | W10299940 | Jumper-CCU P14 |
| 19 | W10280758 | Jumper-CCU P8 |
| 20 | W10280761 | Jumper-CCU To Wide ISO |

