

Whirlpool WGT3300SQ2 08 - BRAKE, CLUTCH, GEARCASE, MOTOR AND PUMP PARTS

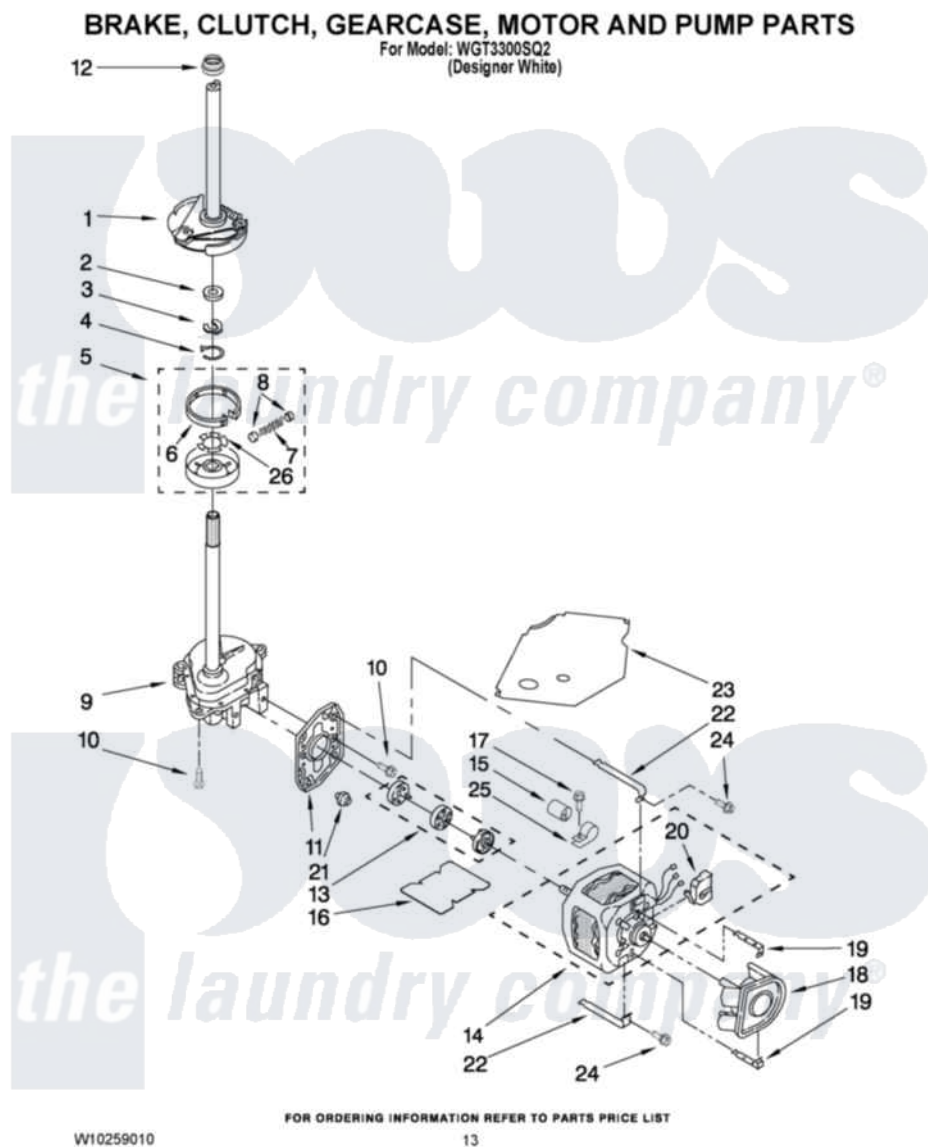

Whirlpool [Residential Whirlpool WGT3300SQ2 Washer/Dryer Parts](#) Parts Diagram 08 - BRAKE, CLUTCH, GEARCASE, MOTOR AND PUMP PARTS
Click on the part number to view part

Item	Original Part Number	Replaced By	Status	Part Description
1	388951	285792		Basketdrive
2	63292			Washer, Spin Tube Thrust
3	62697	W10080230		Ring, Spin Tube Support
4	63283	285353		Ring
5	3951311	285785		Clutch
6	3951308	285790		Lining
7	3946792			Spring And Damper Assembly
8	62646			Cap, Clutch Spring
9	8532118	3360629		Gearcase
10	3357334	3400516		Screw Anti-Rattle
11	62611			Plate, Motor Mount To Gearcase
12	8577374			Seal, Centerpost
13	3364003	285753A		Coupling
14	661600			Motor, Main Drive

15	8572717	Capacitor, Motor Start	
16	8316060	Shield, Tub To Motor	
17	62863	3390631	Screw, 10-16 X 3/8
18	3363892	Pump, Complete	
19	8546127	Retainer, Pump	
20	62850	8529896	Switch, Main Drive Motor
21	62691	Grommet, Motor	
22	W10086010	Retainer, Motor	
23	3362089	Shield, Tub To Motor	
24	3387485	273556	Screw, 10-16 X 5/8
25	3949496	Clamp, Capacitor	
26	3355454	Clip, Main Drive	

the laundry company[®]

the laundry company[®]

the laundry company[®]